

**1** Loosen grub screws for head of fixture and remove screws from base plate

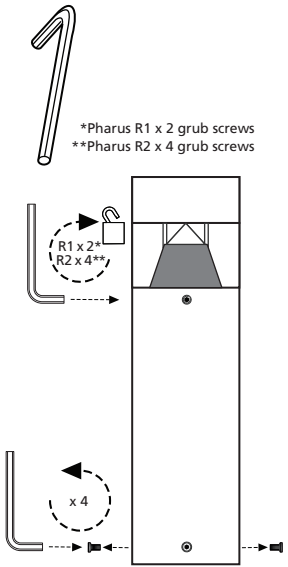

**2** Remove head and base plate

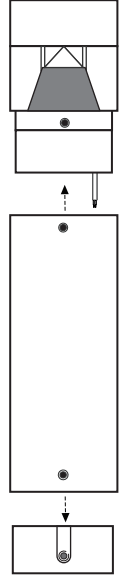

**3** Place base plate on to M8 anchor

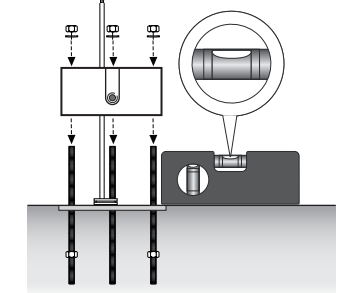

**4** Secure base using x4 nuts & washers

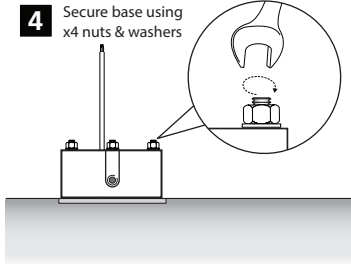

**5** Place body on base

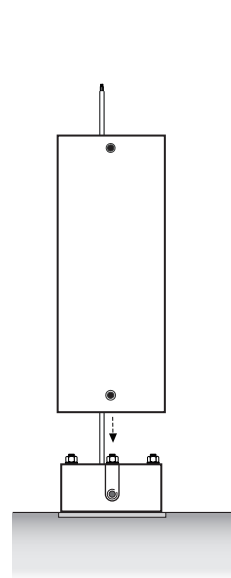

**6** Secure body to base x 4 screws

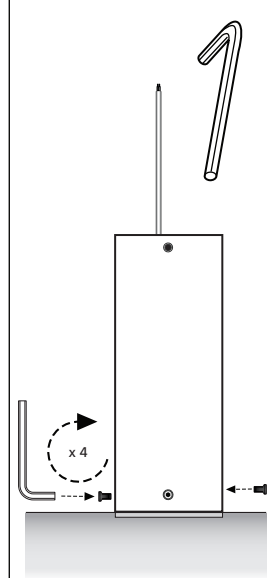

**7** Make electrical connection - head to system cable

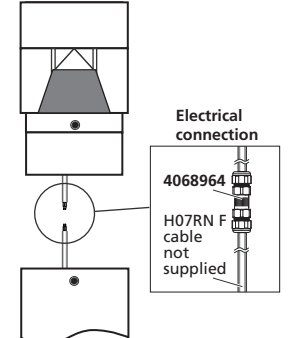

**8** Secure head to body and tighten grub screws

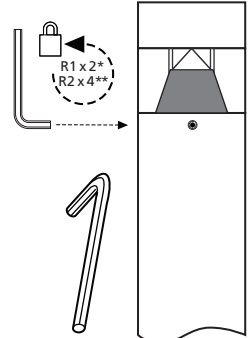

MI/1841-C - 3<sup>rd</sup> ed